

FLEXIBLE CONNECTOR/ COUPLING

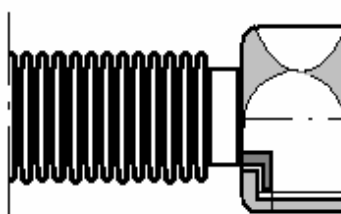
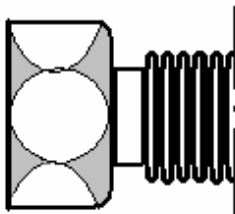

DN mm	Thread Inch	Length		Allowed pressure (bar)		Material		Note
		Compressed	Stretched	Compressed	Stretched	Tube & male thread	Hexagon	
10	3/8	75	130	8	12	Stainless steel	Plated brass	
10	3/8	110	210	8	12	Stainless steel	Plated brass	
10	3/8	200	410	8	12	Stainless steel	Plated brass	
10	3/8	260	520	8	12	Stainless steel	Plated brass	
12	1/2"	75	130	7	10	Stainless steel	Stainless steel	Brass nut optional
12	1/2"	110	210	7	10	Stainless steel	Stainless steel	Brass nut optional
12	1/2"	200	410	7	10	Stainless steel	Stainless steel	Brass nut optional
12	1/2"	260	520	7	10	Stainless steel	Stainless steel	Brass nut optional
12	1/2"	500	1000	7	10	Stainless steel	Stainless steel	
12	1/2"	750	1500	7	10	Stainless steel	Stainless steel	
12	1/2"	1000	2000	7	10	Stainless steel	Stainless steel	
20	3/4"	75	130	5	5.5	Stainless steel	Stainless steel	Brass nut optional
20	3/4"	110	210	5	5.5	Stainless steel	Stainless steel	Brass nut optional
20	3/4"	200	410	5	5.5	Stainless steel	Stainless steel	Brass nut optional
20	3/4"	260	520	5	5.5	Stainless steel	Stainless steel	Brass nut optional
20	3/4"	500	1000	5	5.5	Stainless steel	Stainless steel	
20	3/4"	750	1500	5	5.5	Stainless steel	Stainless steel	
20	3/4"	1000	2000	5	5.5	Stainless steel	Stainless steel	
25	1"	75	130	4	5.5	Stainless steel	Stainless steel	Brass nut optional
25	1"	110	210	4	5.5	Stainless steel	Stainless steel	Brass nut optional
25	1"	200	410	4	5.5	Stainless steel	Stainless steel	Brass nut optional
25	1"	260	520	4	5.5	Stainless steel	Stainless steel	Brass nut optional
25	1"	500	1000	4	5.5	Stainless steel	Stainless steel	
25	1"	750	1500	4	5.5	Stainless steel	Stainless steel	
25	1"	1000	2000	4	5.5	Stainless steel	Stainless steel	
32	1 1/4"	75	130	3.5	5.5	Stainless steel	Plated brass	
32	1 1/4"	110	210	3.5	5.5	Stainless steel	Plated brass	
32	1 1/4"	200	410	3.5	5.5	Stainless steel	Plated brass	
32	1 1/4"	260	520	3.5	5.5	Stainless steel	Plated brass	
40	1 1/2"	110	210	3	5.5	Stainless steel	Plated brass	
40	1 1/2"	200	410	3	5.5	Stainless steel	Plated brass	
40	1 1/2"	260	520	3	5.5	Stainless steel	Plated brass	
50	2"	110	210	2.5	3.5	Stainless steel	Plated brass	
50	2"	200	410	2.5	3.5	Stainless steel	Plated brass	
50	2"	260	520	2.5	3.5	Stainless steel	Plated brass	

All dimensions can be provided in both female thread in both ends and female resp male thread

All nuts stainless steel if not otherwise stated in dimension 1/2" to 1". Brass nut/s optional.

1/2" tube also available with 1/2" thread in one end and 3/4" in the other